

Completed Projects (FY 23/24)				City of Randolph		
Project #	Street Name	Start	End	Description of Work	Length (mi)	Final Cost

One Year Plan - Fiscal Year 2024/2025 Projects (October 1st to September 30th)					City of Randolph	
Project #	Street Name	Start	End	Description of Work	Length (mi)	Est. Cost
M-509(64)	Douglas/Wayne			Rebuild Intersection	0.1	\$ 100,000
M-509(65)	Douglas/Hughson			Rebuild Intersection	0.1	\$ 100,000
M-509(66)	Main/Wayne			Rebuild Intersection	0.1	\$ 120,000
M-509(67)	Nebr./Wayne			Rebuild Intersection	0.1	\$ 90,000
M-509(68)	Nebraska			Rebuild Intersection at Alley	0.1	\$ 45,000

Six Year Plan - Fiscal Year 2025/2026 to 2029/2030 Projects (October 1st to September 30th)					City of Randolph	
Project #	Street Name	Start	End	Description of Work	Length (mi)	Est. Cost
M-509(30)	Douglas St.	Hughson St.	US 20	Remove brick paving, build 8" concrete paving, Douglas St. Hughson to U.S. 20	0.1	\$ 470,000
M-509(55)	Jackson	Jackson St.	E to County Bridge	Concrete paving from the East end of concrete on Jackson, East to County Bridge, Approx. 350'	0.1	\$ 190,000
M-509(22)	Wayne St.	Nebr. St.	Logan Creek	6" asphalt concrete surfacing, Wayne St. from Nebr. St. to Logan Creek	0.1	\$ 200,000
M-509(57)	Hughson St.	Douglas St.	Nebraska St.	Remove brick paving, build 8" concrete paving, Hughson St. from Douglas St. to Nebraska St.	0.1	\$ 667,000
M-509(58)	Nebraska St.	Broadway St.	Wayne St.	Remove brick paving, build 8" concrete paving, Nebraska St. from Broadway St. to Wayne	0.1	\$ 400,000
M-509(59)	Wayne St.	Douglas St.	Nebraska St.	Remove brick paving, build 8" concrete paving, Wayne St. from Douglas St. to Nebraska St.	0.1	\$ 972,000
M-509(69)	E Jackson St.	N Bridge St.	300' E of N Bridge	Add 8" concrete paving parking area on south side of street	0.1	\$ 200,000
M-509(23)	Wayne St.	Logan Creek	E Kemp St.	6" asphalt concrete surfacing, Wayne St. from Logan Creek to E Kemp St.	0.3	\$ 360,000
M-509(24)	Wayne St.	E Kemp St.	Corporate Limits	6" asphalt concrete surfacing, Wayne St. from E Kemp St. to Corporate Limits	0.1	\$ 200,000
M-509(70)	E Kemp St.	100' E of Nebraska St.	E Wayne St.	8" concrete paving, 100' E of Nebraska St. to E Wayne St.	0.2	\$ 400,000
M-509(71)	Pacific St.	W Randall St.	W Kemp St.	7" concrete paving, W Randall St. to W Kemp St.	0.2	\$ 500,000
M-509(72)	Pacific St.	W Lorge St.	W Randall St.	7" concrete paving, W Lorge St. to W Randall St.	0.1	\$ 275,000
M-509(73)	E Hughson St.	Hughson St.	E Jackson St.	7" concrete paving, E Hughson St. to E Jackson St.	0.1	\$ 360,000

RANDOLPH, NEBRASKA

ONE AND SIX YEAR PLAN

FISCAL YEAR 24/25-29/30

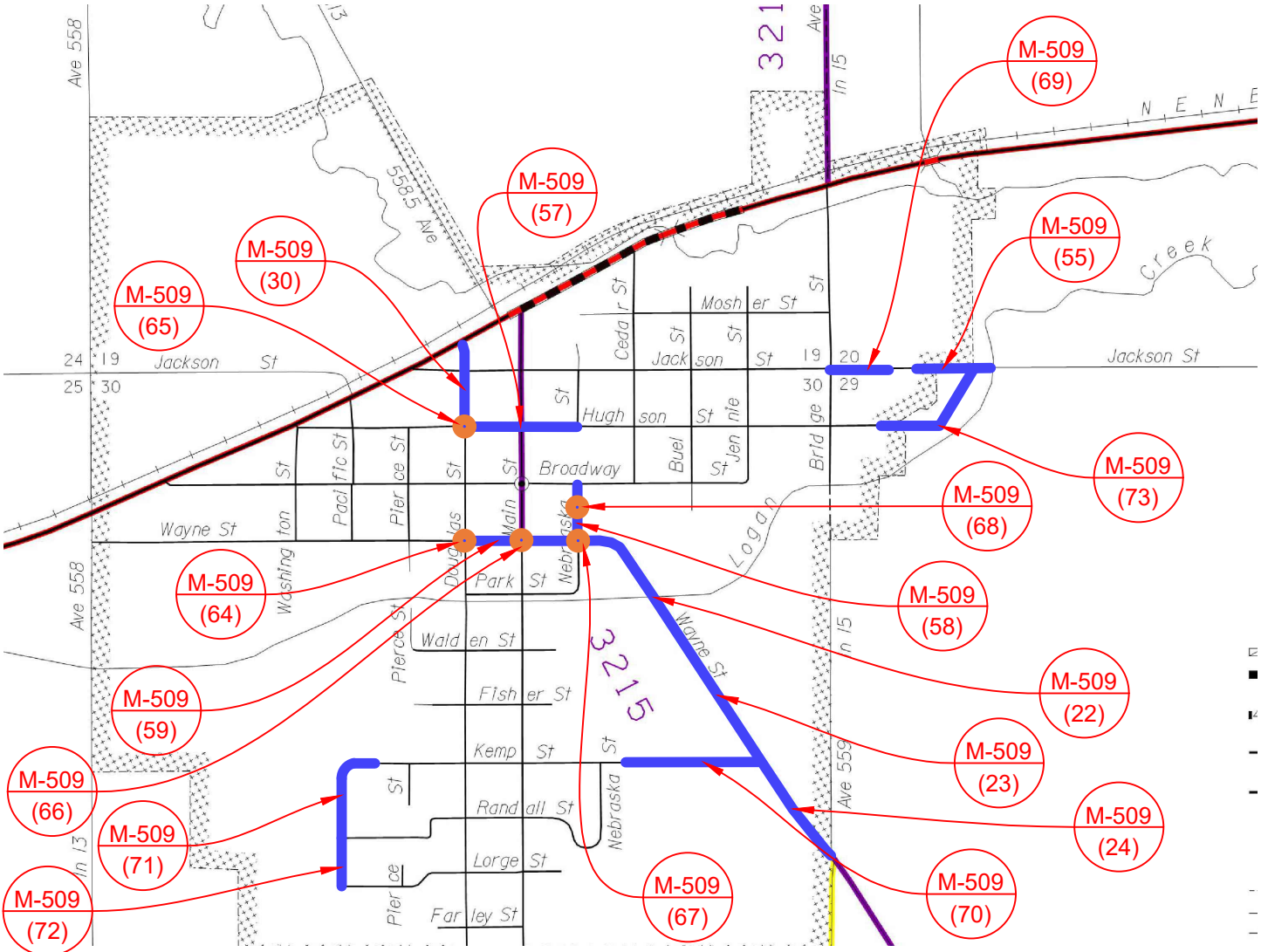

800.723.8567



NATIONAL ROAD CLASSIFICATIONS

- MAJOR COLLECTOR
- MINOR COLLECTOR

PROJECT LEGEND

- 1 YEAR PLAN
- 6 YEAR PLAN

DRAWING NAME: RANDOLPH
 REVISED BY: SMD
 REVISED ON: JULY 17, 2024